

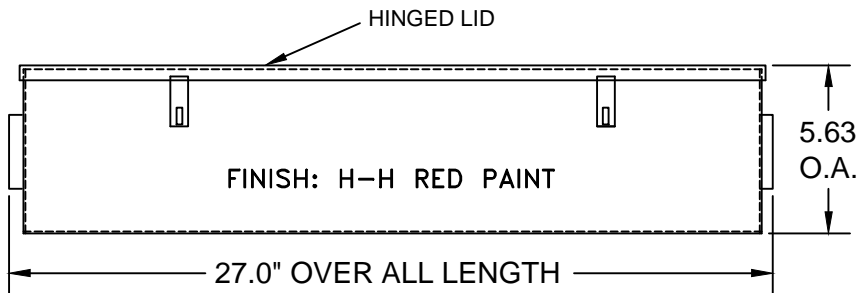

DRAW LATCH (PADLOCKABLE) 2 PLACES



FINISH: H-H RED PAINT

27.0" OVER ALL LENGTH

5.63
O.A.

KIT TO CONTAIN: [Ⓐ]
 4-5000 LBS.(2.5 TON) CS-5 SWIVEL TOP SKATES
 (SEE CS-5 SPEC. DETAIL SHEET FOR ADDITIONAL INFORMATION)
 1- 16 1/2" TURNING HANDLE
 STEEL STORAGE BOX
 (AS SHOWN HERE)

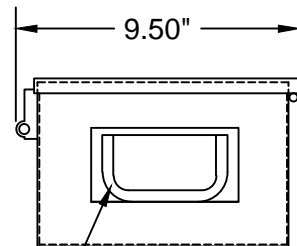

CHEST HANDLES
 FOLD DOWN (BOTH ENDS)



16 1/2" TURNING HANDLE

HEVI-HAUL SKATE

MODEL: CS-20K
 COMPACT SWIVEL KIT
 TOTAL KIT CAPACITY 10.0 TONS
 TOTAL KIT WEIGHT: 143 LBS.

PER SKATE CAPACITY: 2.5 TONS
 (STEEL ROLLERS)
 UNIT WEIGHT: 30 LBS.
 COLOR: HEVI-HAUL RED

ROLLER OPTIONS:
MODEL: CS-20K-P
 POLY (POLYURETHANE) COATED ROLLERS
 TOTAL KIT CAPACITY: 10.0 TONS
 TOTAL KIT WEIGHT: 120 LBS.

NYLON ROLLERS
 (BEARINGS WITH SEALS)
 TOTAL KIT CAPACITY: 10.0 TONS
 UNIT WEIGHT: 101.5 LBS.

OPTIONAL EQUIPMENT:
 SWIVEL LOCK
 EXTRA TURNING HANDLE
 GUIDE ROLLERS

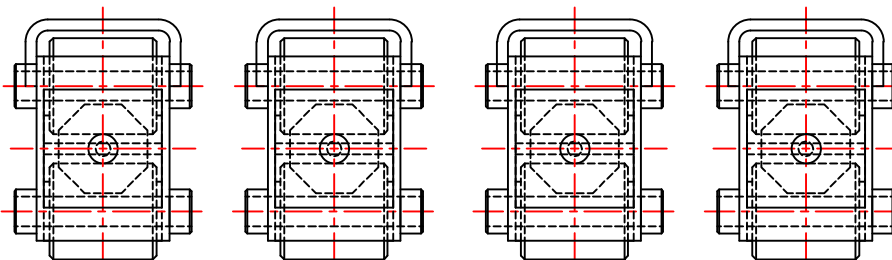

4-5000 LBS.(2.5 TON) CS-5 SWIVEL TOP SKATES [Ⓐ]

A REV 12-29-11 CS-5 W CS-3H



MENOMONEE FALLS, WISCONSIN U.S.A.
 PHONE: 800-558-0577
 262-502-0333
 FAX: 262-502-0260
 WEB SITE: WWW.HEVIHAUL.COM

THIS DRAWING IS THE PROPERTY OF HEVI-HAUL INTERNATIONAL, LTD. ALL THE INFORMATION THEREON IS CONFIDENTIAL AND MUST NOT BE MADE PUBLIC, NOR COPIED, NOR USED TO THE DISADVANTAGE OF HEVI-HAUL INTERNATIONAL, LTD., AND IS SUBJECT TO RETURN ON DEMAND.

REV: A DATE: 01-10-01 DRAWN BY: J.P. WARREN
 SPEC. SHEET MODEL:

CS-20K