

3.25"∅ END ROLLERS  
(4 PLACES)

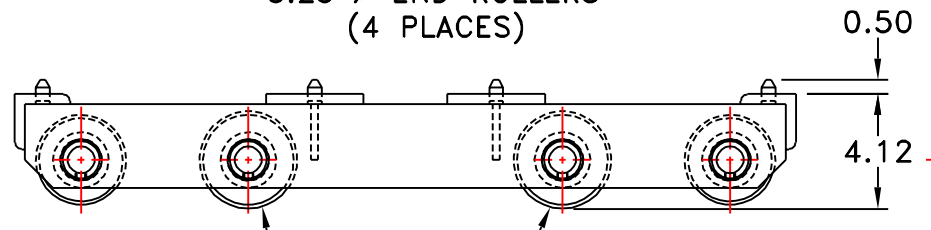

3.5"∅ CENTER  
ROLLERS (4 PLACES)

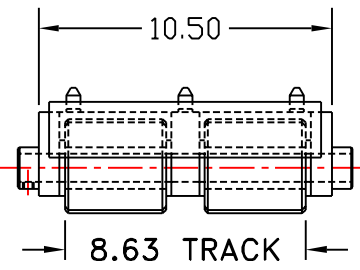

HEVI-HAUL SKATE

MODEL: BB-100  
HEVI-HAUL HEAVY-DUTY SKATE  
CAPACITY: 50.0 TONS  
(STEEL ROLLERS)  
UNIT WEIGHT: 150 LBS.  
COLOR: HEVI-HAUL RED

OPTION AVAILABLE AT NO ADDITIONAL COST  
8 EQUAL (3.25" DIA.) ROLLERS TO MAXIMIZE  
LOAD DISTRIBUTION. 50.0 TON CAPACITY ON  
STEEL ROLLERS

ROLLER OPTIONS:  
POLY (POLYURETHANE) COATED ROLLERS  
STANDARD CAPACITY: 20.0 TONS  
UNIT WEIGHT: 122 LBS.  
ALL EQUAL SIZE ROLLERS CAPACITY: 40.0 TONS

NYLON ROLLERS  
(BEARINGS WITH SEALS)  
STANDARD CAPACITY: 8.0 TONS  
UNIT WEIGHT: 104 LBS.  
ALL EQUAL SIZE ROLLERS CAPACITY: 16.0 TONS

OPTIONAL EQUIPMENT:  
W/O CLEATS  
GUIDE ROLLERS  
FLAT TOP



MENOMONEE FALLS, WISCONSIN U.S.A.  
PHONE: 800-558-0577  
262-502-0333  
FAX: 262-502-0260  
WEB SITE: WWW.HEVIHAUL.COM

THIS DRAWING IS THE PROPERTY OF HEVI-HAUL INTERNATIONAL, LTD. ALL THE INFORMATION THEREON IS CONFIDENTIAL AND MUST NOT BE MADE PUBLIC, NOR COPIED, NOR USED TO THE DISADVANTAGE OF HEVI-HAUL INTERNATIONAL, LTD., AND IS SUBJECT TO RETURN ON DEMAND.

|                   |                |                       |
|-------------------|----------------|-----------------------|
| REV. 2001         | DATE: 01-09-01 | DRAWN BY: J.P. WARREN |
| SPEC. SHEET MODEL |                |                       |

BB-100